

SPECIFICATIONS

Description	Specification
Material	ABS
Backup Plate Dimensions	10" x 10" x 1/8"
Pedestal Dimensions	7" x 6" & 9" x 1.3/8" x 2.3/8"
Actual Weight <i>(Plate & Pedestal)</i>	528g / 18.6 oz.
Color	White

Application Image #1

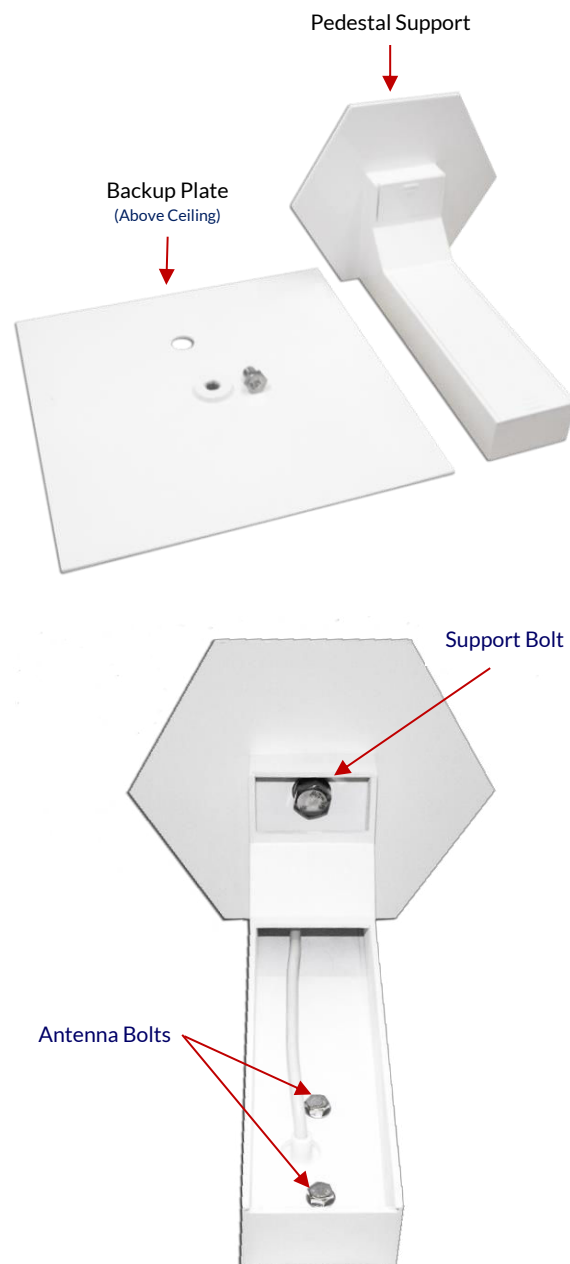

FEATURES:

Available exclusively from JDTECK, this ceiling mount directional antenna bracket was designed in-house for applications that require either a directional source signal from the window of an office building (because there is no access to the roof) or because there is a need to distribute a directional signal internally to a specific area, like down a hallway. It attaches to a suspended ceiling tile with a backup plate above the tile to provide additional support. No coax is visible once installed, and it blends in nicely in an office environment. It is very light weight and installs in a matter of minutes.

- Light Weight
- Low Profile
- Easy to Install
- Perfect for Distributing Signals down a Hallway.